

FUJIIRYŌKI

home use

CALM PLUS⁺

Massage Chair : MR6000

User manual



Category: machinery and appliances
general designation: household electric massage chair

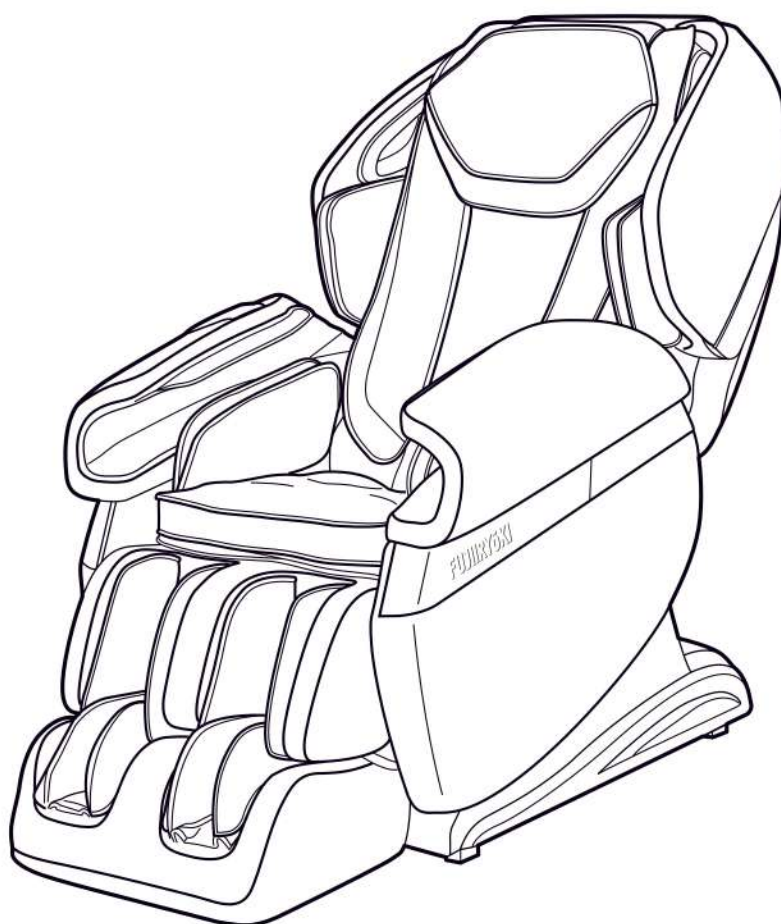

Purpose of use, effect-efficacy

Substitution of massage for home-use

- Thank you very much for purchasing Fujiiryoki massage chair.
- Carefully read this operation manual before use and only use as directed.
- Please read the safety precautions on pages 4-10 before use.
- Keep this operation manual where it will be readily available for future referral.
- Please recycle the outer packaging material where possible.

Contents

Before use

- IMPORTANT SAFETY INSTRUCTIONS 4
- Place massage chair 11
- Before use 14
- Names and Functions of Each Part 18

How to use

- Recline adjustment 22
- settings 23
- Auto programs 24
- Manual massage 26
- How to adjust massage 28



Overhaul and maintenance methods

- Cleaning and maintenance 31
- Troubleshooting 32
- Product specifications 33



MEMO

IMPORTANT SAFETY INSTRUCTIONS



- Read these "Important Safety Instructions" before use and use this product properly
- These important safety instructions are prescribed to ensure correct usage of the product, and to prevent injury and damage to the user and other persons.
- Following are the display and contents.
- Please keep to the regulations as these are important instructions for your safety.

 DANGER	Improper usage may result in serious injury or death.
 WARNING	Improper usage may result in injury or damage to property.*

*Property refers to houses, household belongings, domestic animals and pets.

	<p>⊘ Prohibited actions</p> <p>The prohibited action is illustrated inside the illustration (for example, the illustration on the left refers to "Prohibiting disassembling")</p>
	<p>● Directives, actions which are compulsory</p> <p>The prohibited action is illustrated inside the illustration (for example, the illustration on the left refers to "unplugging the power plug")</p>

- Always keep this operation manual where it will be readily available for referral.
- Attention: When disposing of this product and/or its accessories, do so in accordance with local laws and regulations. For details, please refer to your local authority.

 DANGER	
	<p>Because this equipment has a built-in heater and the surface becomes hot, person who are not sensitive to heat should pay attention to use.</p> <p>Pay full attention when it falls under the following.</p> <ul style="list-style-type: none"> •elderly, ailing person, those who cannot operate by themselves •persons who took medicine that cause drowsiness (sleeping pills, cold medicine) •persons with heavy drinking, heavy tiredness •persons with hematogenous disorder (diabetes, etc.) •persons who receive a note from the doctor •people with weak temperature sense. <p>There is a risk of low temperature burns, dehydration.</p>
	<p>The following persons must consult a medical physician before using this product.</p> <ul style="list-style-type: none"> •Persons using a medical electronic device embedded in the body such as a pacemaker susceptible to the electromagnetic disturbances. •persons with malignant tumors. •persons with heart diseases. •persons who are pregnant or those immediately after childbirth. •persons who suffer from paresthesia related to peripheral circulatory disturbance due to diabetes etc. •persons with wounds on their skin. •persons in need of repose. •persons with Temperature sensory loss. •persons with body temperatures exceeding 38°C. (when strong acute inflammation symptoms, malaise, hills, blood pressure fluctuations are observed, when debilitated) •persons with herniated discs. •a person with tendovaginitis. •persons who suffer from osteoporosis, spinal column fractures, or acute pains. •persons with abnormalities in the spine, or those whose spines are bent. •persons who feel an abnormality on the body not prescribed above, persons in treatment by a doctor.



DANGER

	<p>If the chair stops moving or any abnormalities occur, unplug the power plug and contact the point of purchase for an Electrification, short circuits and fire may occur.</p>
	<p>Take care of the movements of the knead balls when massaging around neck. Avoid excessive massaging or massaging the front of the neck. Accidents or injuries may occur.</p>
	<p>When reclining or lowering the footrest, always check underneath and surroundings the footrest for people, pets, and other items. Accidents or injuries may occur.</p>
	<p>When reclining or lowering the footrest, be careful not to get hands, fingers, feet, head caught underneath the footrest or backrest. ●underneath the chair itself ●backrest, seat, clearance of armrest ●clearance of footrest, seat, armrest ●underneath the footrest, the back of footrest ●clearance between arm and armrest ●behind the backrest Accidents or injuries may occur.</p>
	<p>Before use, check underneath the back pad to make sure that there are no rips or tears in the cover cloth of the seat back. (Should there be any rips or tears, no matter how small, immediately discontinue use, disconnect the power cord, and ask for repairs to be conducted). Continued use with rips or tears in the cloth of the seat back may cause electric shocks or injuries.</p>
	<p>Always unplug this appliance from the electrical outlet immediately after using and before cleaning.</p>
	<p>Not long term use of heater and same spot on the body If heat is used on the same spot for a long time, low temperature burns may occur even if the temperature is comparatively low in 40-60°C.</p> <div><p>About low temperature burn</p><ul style="list-style-type: none">●Low temperature burn effect the deep part of the skin and shows red specks or blisters.●In case red specks or blisters are found, consult a medical physician immediately.</div>
	<p>The following people are strongly recommended not to use this product. Certain prohibited from receiving a massage by a medical physician. (for example, those suffering from thrombosis, severe aneurysm, acute varicose veins, various kinds of dermatitis and skin infections (including inflammations of subcutaneous tissue), etc.)</p>
	<p>Do not remove, rip or cut the cover of the chair (backrest, footrest) on purpose. Never use the chair with the cover removed or torn as clothes and hair may get caught in the knead balls.</p>
	<p>Do not use the chair other than on the designated voltage. Fire or electrification may occur.</p>
	<p>Do not use the chair when the power cord or its plug is damaged, or when the receptacle is loose. Contact your point of purchase for repairs if the power cord or power plug are damaged in any way. Continued usage may result in electric shocks, shortage, or even fire.</p>
	<p>Surely plug the power plug to the root and keep away from the dust. Doing so may cause damage, fire and electrification.</p>
	<p>Do not allow unattended children or people unable to declare their own intentions to use this chair. Do not allow infants near the chair. Electrification or injuries may occur.</p>
	<p>Do not allow children to play or get on the chair. Accidents or injuries may occur.</p>
	<p>Do not connect or disconnect the power plug with wet hands. Electrification may occur.</p>

IMPORTANT SAFETY INSTRUCTIONS



DANGER

	Never use pins or other metallic fasteners with this appliance.
	Carefully examine the covering before each use. Discard the appliance if the covering shows any sign of deterioration, such as checking, blistering, or cracking.
	Do not use or store in the bathrooms or places of high humidity or moisture. Electrification, fire, accidents, and moulding may occur.
	Never remodel or decompose/repair by yourself. Fire or injury due to abnormal action may occur.



WARNING

	Usage of this product should be limited to 30 minutes for each use. Continual use on the same part of the body should be limited to 5 minutes. Prolonged use may damage muscles and nerves.(Only use for 30 minutes per day.)
	The following persons should consult a medical physician before using this product. ●persons whose muscles have become weak due to increasing age, and those who are of slim build. ●persons suffering from lower back pain caused by bones or internal organs. ●persons easily bruised, susceptible to sprains. ●persons who suffer from intense motion sickness. ●persons who have undergone internal organ or heart operations.
	If any rashes, reddening of the skin, itches or similar symptoms appear after using this product, immediately stop using and consult a physician. Accident and ill health may occur.
	An appliance should never be left unattended when plugged in. Unplug from outlet when not in use, and before putting on or taking off parts. To disconnect, turn all controls to the off position, then remove plug from outlet. This may result in accidents due to children's mischief.
	Use the chair on a level surface. Do not use outdoors. Damage or accidents may occur.
	Make sure operation buttons and timers are operating normally before use. Accidents or injury may occur.
	Read the operation manual once again and confirm the product is operating normally before using the chair after a prolonged period of non-use. Accidents or injury may occur.
	Confirm no items get caught in the chair (backrest, footrest, armrest) before use. Never drop or insert any object into any opening. Accidents or injury may occur.
	Do not place feet or hands on the footrest when the footrest is retracting. Accidents or injury may occur.
	When any physical abnormalities appear or are felt during operation, stop using the product immediately and consult a physician.
	Sit down slowly after confirming the knead balls are located at the storage position. Accidents or injury may occur.
	Use weak stimulation massage when you start to use. Injury may occur.



WARNING



Make sure the ground terminal is installed. Damages or electrification may occur when ground terminal is not installed.



Turn the power switch OFF and unplug the power cord immediately in times of power shortages. When power is restored accidents may occur.

Unplug the power plug by holding the actual power plug and not the cord. This may cause electrification, short circuits, or fire.

Unplug the power plug when not using the chair.
This may cause a fire due to insulation degradation by dust or humidity.

When maintaining the chair always unplug the power cord. This may cause electrification or injury.



Never operate the appliance with the air openings blocked.
Keep the air openings free of lint, hair, and the like.

Never drop or insert any object into any opening.

To disconnect, turn all controls to the off position, then remove plug from outlet.

The appliance is intended for household use.

Temperatures sufficiently high to cause burns may occur regardless of the control setting. Do not use on an infant or invalid or on a sleeping or unconscious person. Do not use on sensitive skin or on a person with poor blood circulation. Check the skin in contact with the heated area of the appliance frequently to reduce the risk of blistering.

Do Not Crush - Avoid sharp folds.

Do not damage the power cord or power plug.

- Do not hurt •Do not damage •Do not process •unreasonably bend or pull.
- Do not twist •Do not tie •Do not place heavy items on the power cord. •Do not get the power cord caught, especially when moving the chair.

Never operate this appliance if it has a damaged cord or plug, if it is not working properly, if it has been dropped or damaged, or dropped into water. Return the appliance to a service center for examination and repair.

Continued usage may result in electric shocks, shortage, or even fire.

Do not use immediately after eating or consuming alcohol. Nausea, illness, accidents or injury may occur.

Do not close to stoves or other sources of fire, nor smoke whilst using the chair. Do not use on heated carpets or other heating equipment. Do not operate under blanket or pillow. Excessive heating can occur and cause fire, Electric shock, or injury to persons. Keep the cord away from heated surfaces. This may cause fire.

Do not stand on the seat, or get on the seat back, footrest, arm or shoulder portion of the chair. The user or chair may rollover and injury or accidents may result.

Do not stand or sit down on upper part of the backrest, the front of the seat or on the footrest when the chair is reclining. The user or chair may rollover and injury or accidents may result.

Do not try to sit or get up from the chair when the chair is reclining or the footrest is elevated. The user or chair may rollover and injury or accidents may result.

IMPORTANT SAFETY INSTRUCTIONS



WARNING



Do not use accessories other than those which accompany the chair. Doing so may cause product malfunction.

Do not use the chair whilst wearing earrings, necklaces, scarves, or other ornaments. This may cause injury.

Do not use the chair whilst wearing hard objects on the head, such as hair ornaments. This may cause injury.

Do not use thigh or hip massage with hard objects in pockets. This may cause accidents or injury.

Do not use while naked. Direct massages on the naked body may damage the skin.

Do not use on the elbow, knee, head, abdomen areas. Do not get hands or feet caught in the knead balls. Injuries may occur.

Do not pull out the power cord, or turn off the power switch whilst using the chair. This may cause accidents or injury.

Do not sleep whilst using the chair. This may cause ill health or injury.

Do not move the chair while people or items are on the chair. Damage or injuries may occur.

Make sure no more than 1 person is on the chair at any one time. Doing so may result in damage to the chair or injury.

Do not wipe with benzine, paint thinner or alcohol, nor spray with any pharmaceutical sprays. This may cause fire or electrification.

Not to be used for purposes other than massage purposes. This may cause damage or accidents.

Do not use other therapeutic equipment whilst using this product. This may cause ill health or accidents.

Do not haul the chair itself or move with the casters on the floor where it easily gets scratches.

Do not overturn the chair or subject the chair to any strong shocks. Damage or injury may occur.

Do not operate where aerosol (spray) products are being used or where oxygen is being administered.

Use this appliance only for its intended use as described in this manual. Do not use attachments not recommended by the manufacturer.

Do not carry this appliance by supply cord or use cord as a handle.

Never operate the appliance with the air openings blocked. Keep the air openings free of lint, hair, and the like.

Close supervision is necessary when this appliance is used by, on, or near children, invalids, or disabled persons.



WARNING



Never operate this appliance if it has a damaged cord or plug, if it is not working properly, if it has been dropped or damaged, or dropped into water. Return the appliance to a service center for examination and repair.

Keep the cord away from heated surfaces.

Use heated surfaces carefully. May cause serious burns. Do not use over insensitive skin areas or in the presence of poor circulation. The unattended use of heat by children or incapacitated persons may be dangerous.

Keep children away from extended foot support, back support (or other similar parts).

Connect this appliance to a properly grounded outlet only. See Grounding Instructions.

This appliance is not intended for use by persons (including children) with reduced physical, sensory or mental capabilities, or lack of experience and knowledge, unless they have been given supervision or instruction concerning use of the appliance by a person responsible for their safety.

Children should be supervised to ensure that they do not play with the appliance.

This appliance can be used by children aged from 8 years and above and persons with reduced physical, sensory or mental capabilities or lack of experience and knowledge if they have been given supervision or instruction concerning use of the appliance in a safe way and understand the hazards involved.

Cleaning and user maintenance shall not be made by children without supervision

Please do not listen at high volume.

Listening at a high volume for a long time may damage your hearing.

IMPORTANT SAFETY INSTRUCTIONS

Grounding instructions



DANGER

Improper connection of the equipment-grounding conductor can result in a risk of electric shock. Check with a qualified electrician or serviceman if you are in doubt as to whether the product is properly grounded. Do not modify the plug provided with the product – if it will not fit the outlet, have a proper outlet installed by a qualified electrician.



WARNING

Ground should be installed firmly. When the ground is not installed, it may cause electric shock at the time of trouble and short circuit.

※ This product must be grounded. If it should malfunction or breakdown, grounding provides a path of least resistance for electric current to reduce the risk of electric shock. This product is equipped with a cord having an equipment-grounding conductor and a grounding plug. The plug must be plugged into an appropriate outlet that is properly installed and grounded in accordance with all local codes and ordinances.

Grounding methods

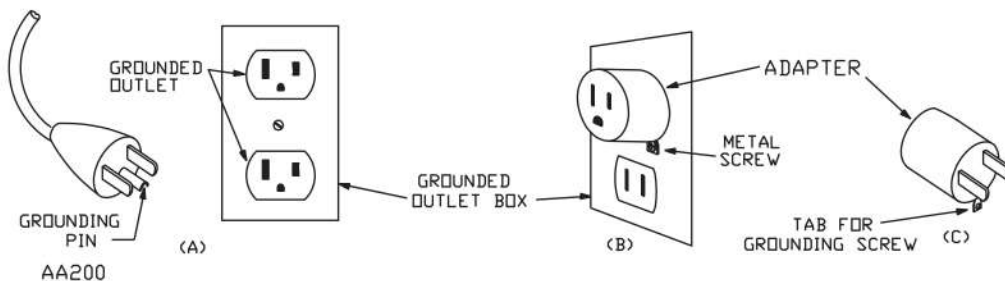

※ This product is for use on a nominal 120-V circuit, and has a grounding plug that looks like the plug illustrated in sketch A in Figure 86.1. A temporary adapter that looks like the adapter illustrated in sketches B and C may be used to connect this plug to a 2-pole receptacle as shown in sketch B if a properly grounded outlet is not available. The temporary adapter should be used only until a properly grounded outlet (sketch A) can be installed by a qualified electrician. The green colored rigid ear, lug, or the like extending from the adapter must be connected to a permanent ground such as a properly grounded outlet box cover. Whenever the adapter is used, it must be held in place by a metal screw.

When there is no ground terminal in the power outlet

Before purchase, discuss with electric shop, dealer and do the grounding (D-Class<Class-D> installation work/cost).

Place massage chair

Required space for installation

Make sure there is enough space so that the massage chair can be tilted, and the back end of the massage chair should be at least 14 inches away from the wall.

Do not expose the massage chair to direct sunlight or high-temperature environments (such as in front of heating equipment). For long-term use in designated locations, it is recommended to lay soft cushions. When laying the mat flat, The size should be enough to cover the area where the machine contacts the floor and the area where the feet contact the floor.

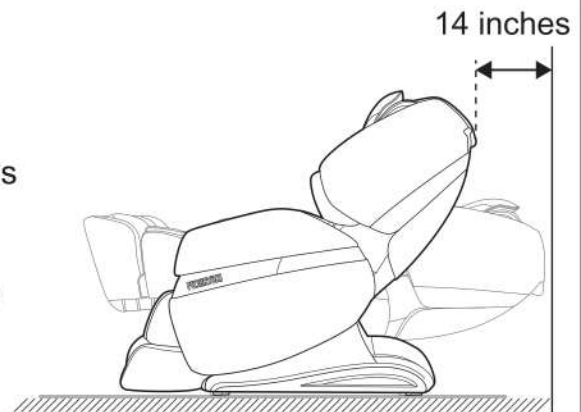

How to lift the massage chair

Support the bottom sides of the stand, then lift and move. Since the machine is heavy, please be careful when carrying it to avoid straining your back. (This machine must be carried by two or more persons.)

1. Please lift the massage chair to move it on fragile surfaces such as wooden floors.
2. When moving on a wooden floor, it is recommended to lift the chair to avoid damages on the floor by the casters. When lifting and moving the chair to a designated position and lowering it, Be careful to keep your hands and feet out of the way to avoid the severe injuries. Do not let go of the machine until it is completely in flat position to prevent damage on the floor. It is recommended to place mats or other protectors on the floor.

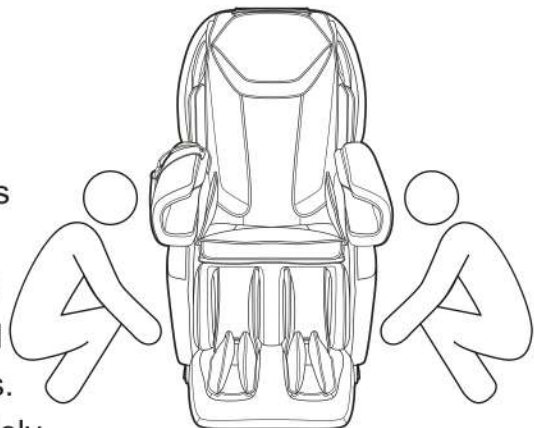

Place massage chair

How to move the massage chair by a person

Use the rear casters to move the massage chair. According to the method shown in the picture, tilt the chair downwards and backwards about 45° to move it.

Note: Do not press down too much to avoid product damage or injury to the carrying person by falling down the chair.



1. Before moving, you need to shut down the machine correctly, completely restore the backrest and legrest position, and then remove the power supply from the product.
2. The product must be left empty when moving. Do not allow people, pets or debris to stay on the product.
3. When using the casters to move the chair, Avoid obstacles exceeding 1inch in height or 1inch in width.
4. The casters are not designed for long-distance movement. For distances exceeding 50 meters, move the product slowly and steadily in short segments.

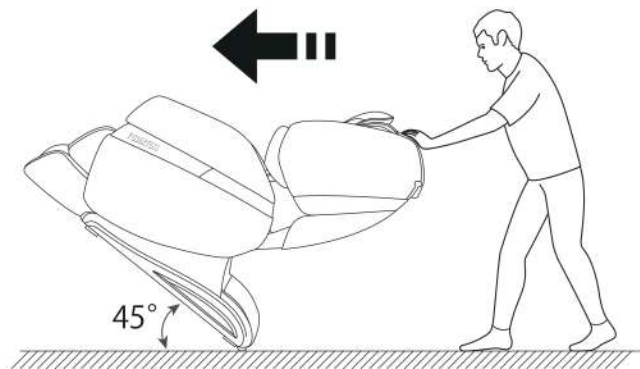

How to set the armrest for use

1. The armrests arrive in a space-saving position to minimize the package size.
2. Before using the massage chair, widen armrests by pulling them outward after unlock the key as shown in the illustration below.
3. After widening the armrest, secure the lock before use.

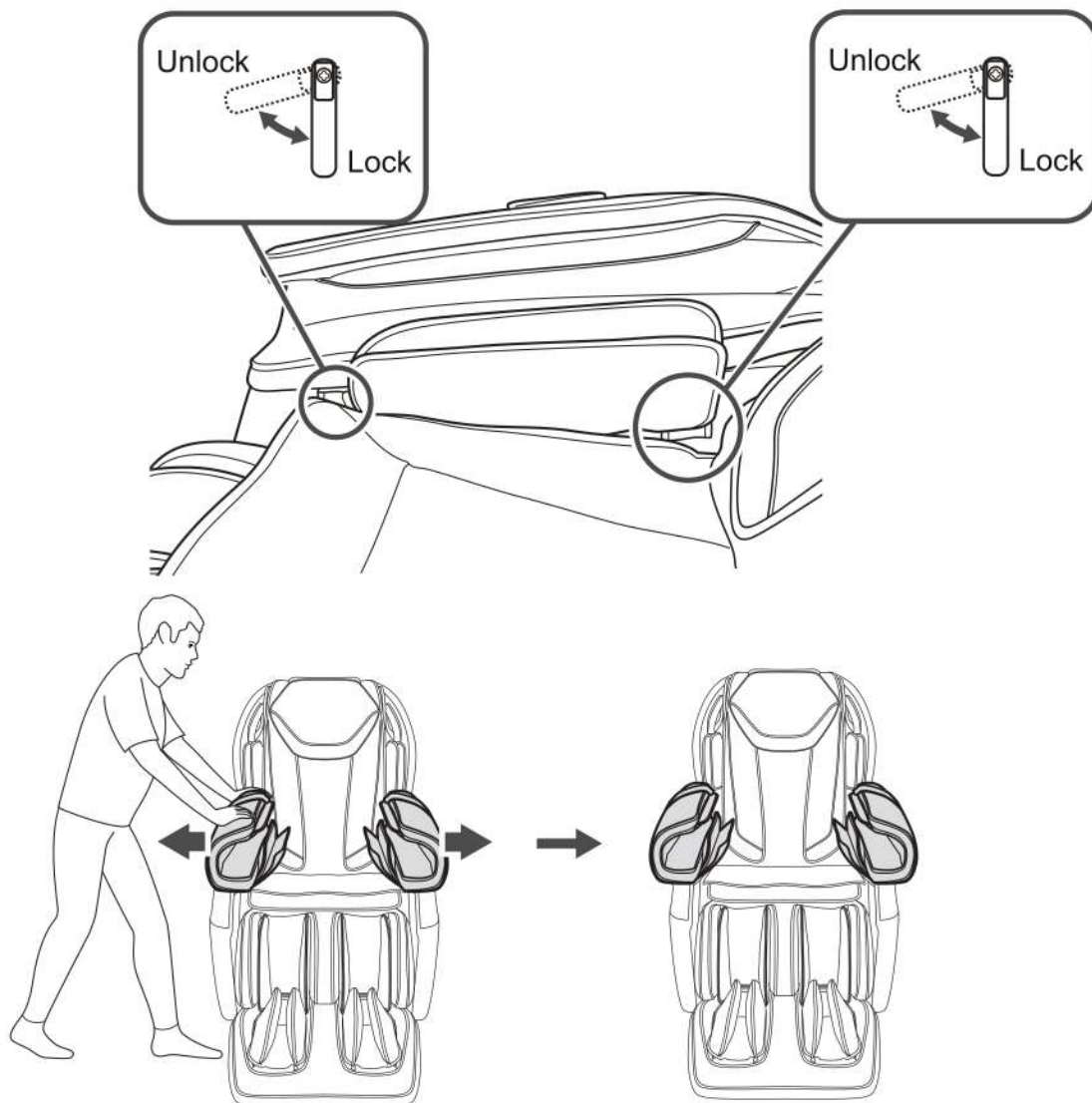

Failure to fully extend the armrests may result in an error beep and chair stoppage during operation.

Before use

Check around

Make sure there are no people, pets, or other objects around the unit.



CAUTION

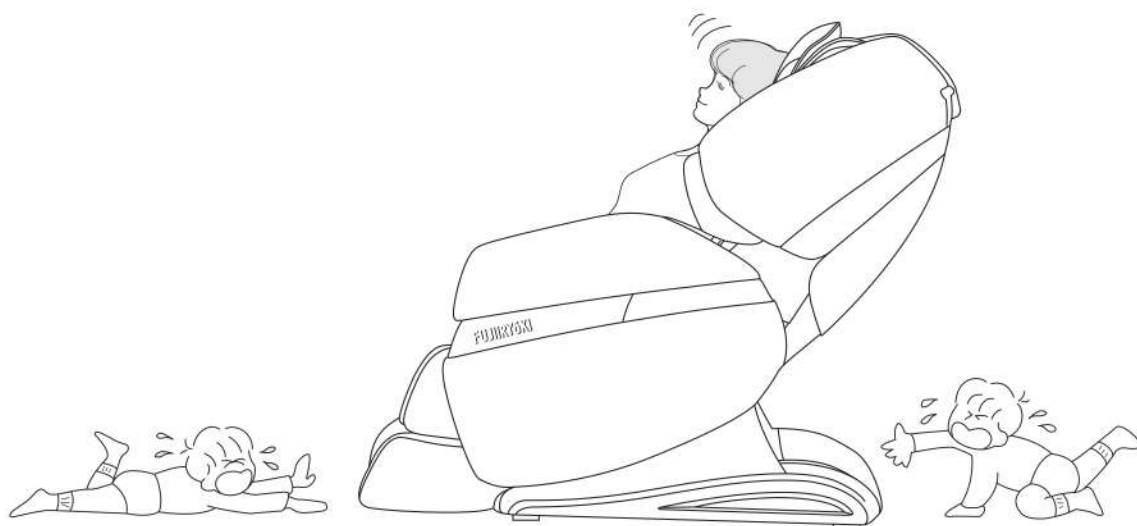

Anti-Pinch Safety : Anti-Pinch Safety System

Explanation of Pinch Sensing System

The lower part of the backrest of this device is equipped with an anti-pinch function. During the reclining/upright movement, if an object touches the anti-pinch sensing area, the anti-pinch function is activated and the unit enters error mode. Please remove the object from under the backrest.

CAUTION

Built-in anti-pinch sensor strip.

Anti-pinch sensing position
between the rear cover and
the lower cover.

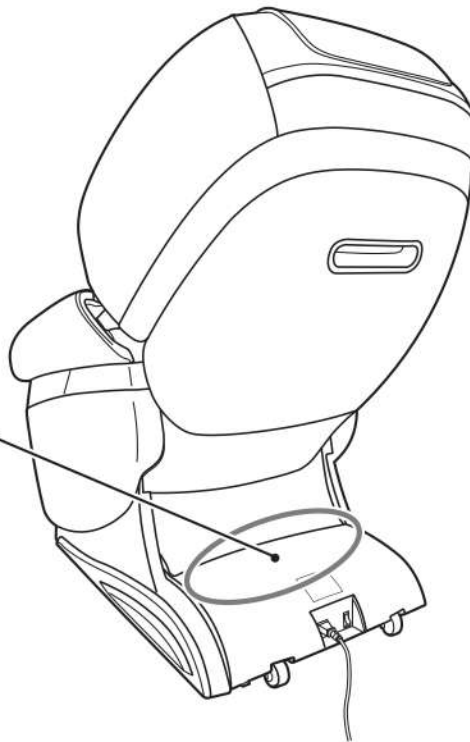

Before use

Turn on the power

CAUTION

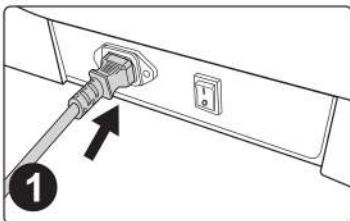

1
Connect the power cord on the chair

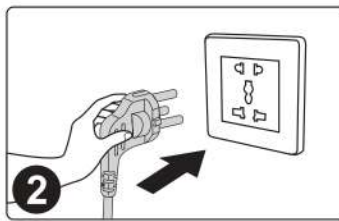

2
Connect to power source

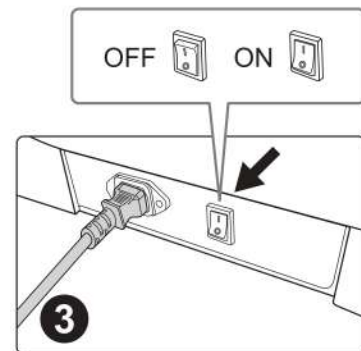

3
Turn on the power switch ("I" position)

DANGER

Please check whether the power cord and power plug are damaged before use.
Please supply power to this product in accordance with the calibrated working power requirements of this product.
It is strictly prohibited to use power supply other than the rated power supply of this product.
It is strictly prohibited to connect various power conversion devices to power this product without authorization.

MEMO

Names and Functions of Each Part

Chair

Front Side



- ① Headrest
Flips backward during massage.
- ② Back pad
Lean back comfortably on backrest.
- ③ Remote Controller
Starts massage.
- ④ Controller Storage Bag
Stores the controller.
- ⑤ BLUETOOTH Speaker
Enjoy music through BLUETOOTH.
- ⑥ Heater
Built-in heater in back pad.

Back side

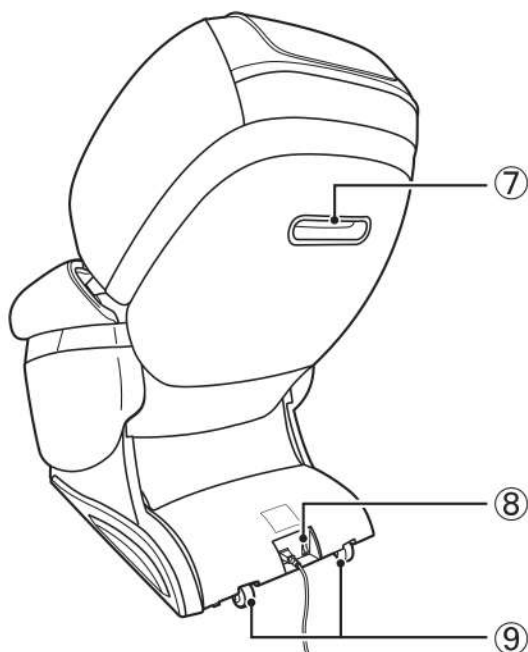

- ⑦ Handle
Hold when lifting.
- ⑧ Power switch
Turns the power of the main unit on and off.
- ⑨ Casters for moving

Massage area

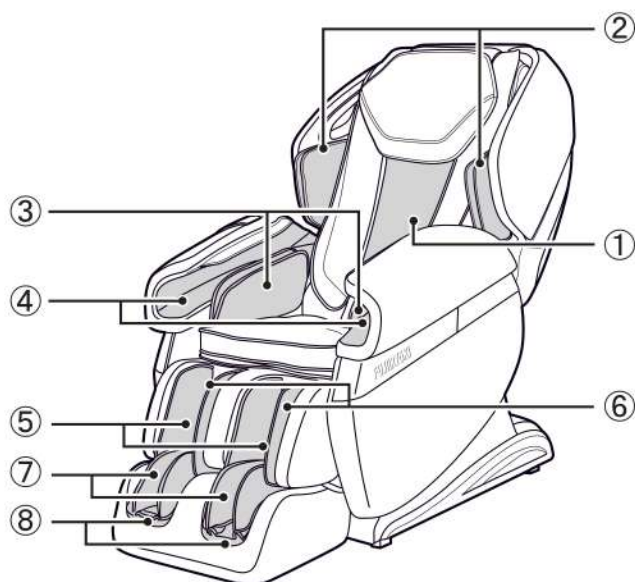



- ① **Backrest**
Massages the entire back with the massage balls.
- ② **Shoulder part**
Air massage of the shoulders.
- ③ **Seat Side**
Air massage around pelvis.
- ④ **Arm**
Air massage of the forearms from the palms of the hands.
- ⑤ **Calf**
Air massage of the calves.
- ⑥ **Back of calf**
Roller massage of the back of the calf.
- ⑦ **Ankle section**
Ankle air massage.
- ⑧ **Foot sole**
Roller massage of the sole of the foot.

Names and Functions of Each Part

Remote Control



●Message Selection

①		Power button	Turn power on/off
②		Pause button	Press to stop the massage instantly, and press again to resume.

Remote Control: Home Menu

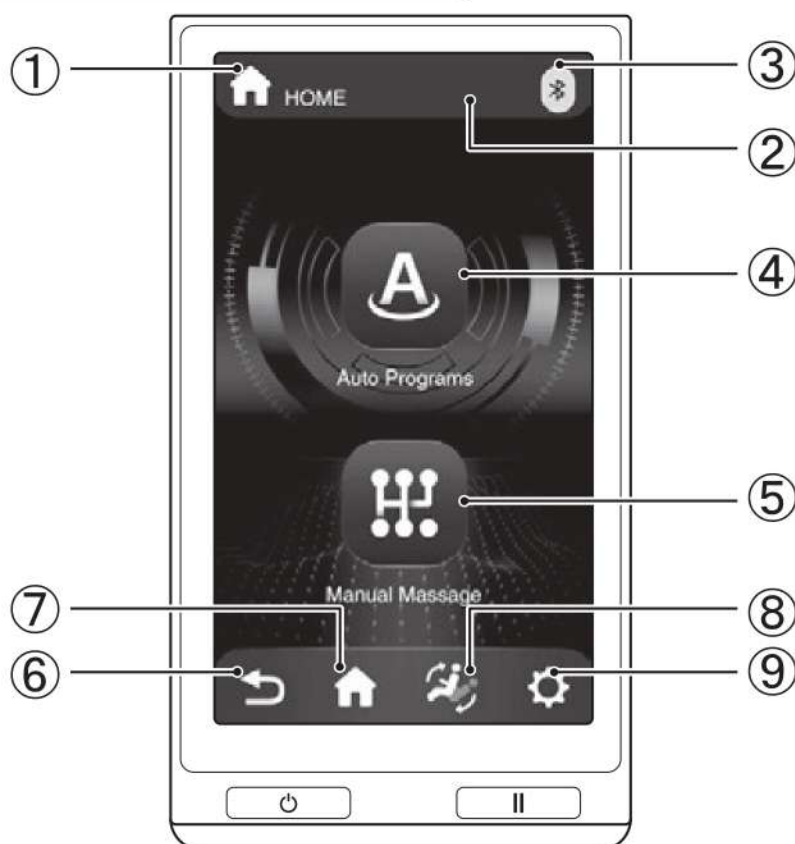

•Status Area

①		Selection Display	Displays the contents of the current selection
②		Timer display area	Displays the remaining time for massage
③		Bluetooth display	Displays the Bluetooth connection status

•Message selection

④		Auto programs	Selection can be made from among 12 types of automatic courses
⑤		Manual massage	Manually select the preferred massage options

•Tools

⑥		Back Button	Return to Massage Operation Screen
⑦		Home	Display the home screen
⑧		Reclining	Adjust the reclining options
⑨		Settings	Open various settings



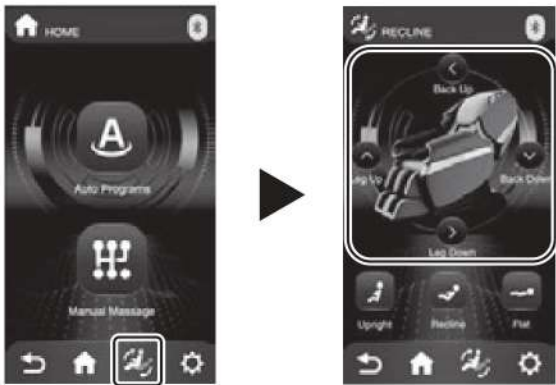

How to use

Recline Adjustment

1. Press the recline button and adjust the recline to your preference.







• For manual adjustment, press and hold the adjustment button.

 Back Up	 Back Down	Recline Button	Adjust the angle of the backrest.
 Leg Up	 Leg Down	Leg Adjustment Button	Adjusts the angle of the legs.

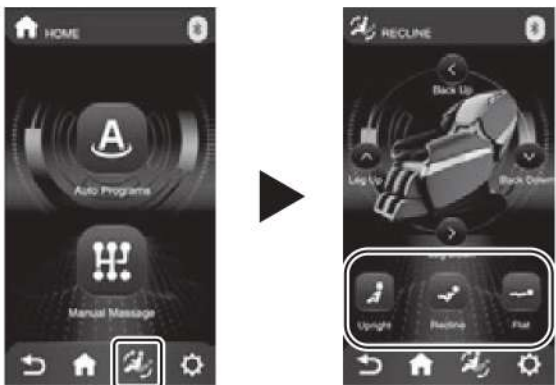
For automatically recline to a specific angle

1. Press the chair angle button corresponding to your desired angle.



 Upright	Upright button	Returns the recliner/legrest to a stored position.
 Recline	Recline button	To recline to a state suitable for massage
 Flat	Flat button	To recline to the flat position.

Setting

1. Press the setting button.



2. Adjust settings according to your preference.

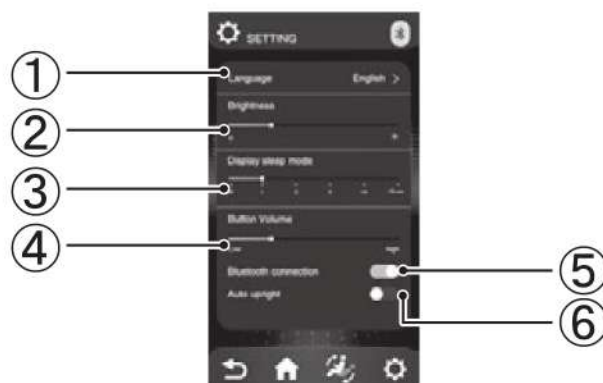

①	Language	Language Setting	Change the display language
②	Brightness	Brightness	Adjust the brightness of the remote control display
③	Display sleep mode	Screen Off Time	You can adjust the time for the screen to turn off when there's no activity on the remote control
④	Button Volume	Volume Control	Adjust the volume of the remote control's operation sounds
⑤	Bluetooth connection	Bluetooth Connection	Turn the Bluetooth function ON/OFF
⑥	Auto upright	Automatic chair restoring	Enable/disable the automatic rising function after the massage ends

How to use

Auto programs

1. Turn on the power.



2. Press "Auto programs" to select a course.



3. Body Scan starts automatically.

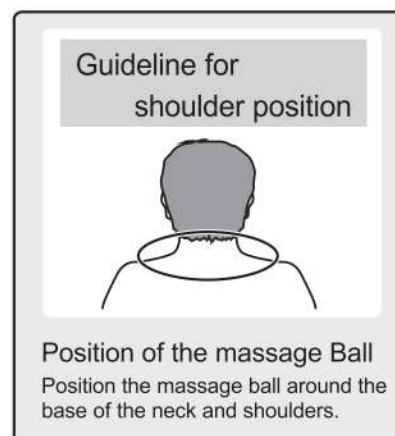
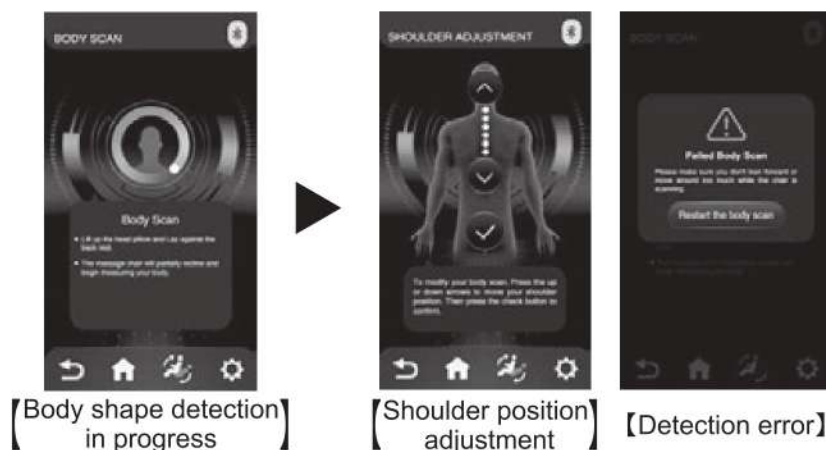



- If the bodyscan fails, press "Restart the body scan" to perform the body scan again.
- For the proper body scan, please sit deeply and lean against the backrest.
- If the shoulder position is incorrect, manually adjust it by pressing the up or down button and confirm to start the massage.

4. The auto program starts.







【Massage Screen】

●Home Menu





	Auto programs	Choose from 12 different automatic courses: 4 for the whole body, 4 for stretching, and 4 for specific body parts
	Manual massage	Start a manual massage Details are described on page 26

●Automatic course contents





Whole body course

	Swedish	A thorough and comprehensive massage that releases knots and fatigue throughout your entire body
	Gentle	A soothing massage that uses light strokes and gentle pressure to ease tension
	Deep Tissue	A massage that promotes deep relaxation and eases muscle fatigue
	Relax	A nurturing massage with soft, flowing movements

Stretch Course

	Yoga Stretch	Unwind and gain flexibility with a comprehensive yoga program
	Deep Stretch	Stretching the entire body vigorously
	Slow Stretch	Experience deeper range of motion with more intensive Stretches
	Air Stretch	Air stretch techniques provide effortless stretching in comfort

Focus course

	Neck	Targeted neck massage course
	Shoulder	Targeted shoulder massage course
	Lumbar	Targeted lower back massage course
	Glutes	Targeted buttocks massage course

How to use

Manual message

1. Turn on the power.



2. Select the Manual message.



【Home Screen】

3. Manual massage starts.



Display of current
massage technique

【Manual massage screen】

- After selecting the manual massage, the default setting is kneading.
- See page 28 for information on how to adjust the manual massage.

●Message Adjustment

	Message adjustment button	To adjust the massage technique, air massage setting, massage range.
---	---------------------------	--

How to adjust massage

Auto programs

1. Each items can be adjusted according to your preference.



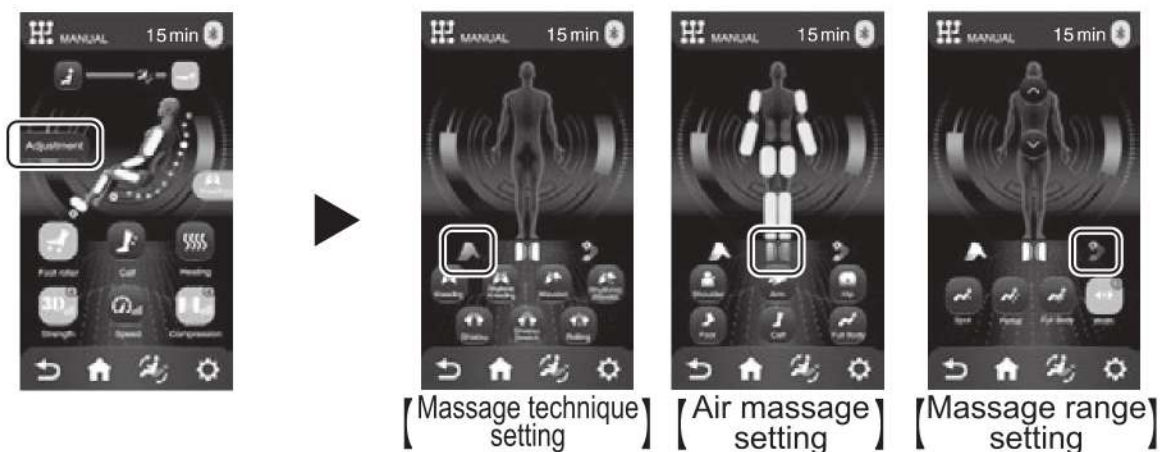

- In the auto program, "speed" button is greyed out and cannot be adjusted.

Manual message









- To adjust the massage technique, air massage setting, massage range, press the "Adjustment" button to choose your desired options in 3 categories.
- After several seconds of inactivity, or pressing the "return" button returns to the massage operating screen.

●Recline adjustment

	To upright position	The backrest raises and the legrest lowers upon activating the button
	To flat position button	The backrest lowers and the legrest raises upon activating the button







●Massage options in the massage operating screen

	Foot roller	Turn ON/OFF the foot roller
	Calf	Turn ON/OFF the calf roller & airbag rubbing massage
	Heater	Turn ON/OFF the heater
	Massage ball strength	Adjust massage intensity in 4 levels with each button press
	Massage ball speed	Adjust massage speed in 5 levels with each button press
	Air Massage Strength	Adjust the air massage intensity in 5 levels with each button press

●Massage adjustment







	Massage adjustment button	To adjust the massage technique, air massage setting, massage range
---	---------------------------	---

●Massage Technique setting (Manual massage only)





	Kneading	Kneading massage
	Rhythmic Kneading	Variable-speed kneading massage
	Wavelet	Kneading and Tapping massage
	Rhythmic Wavelet	Variable-speed kneading and Tapping massage
	Shiatsu	Acupressure massage
	Shiatsu Stretch	Acupressure and stretching massage
	Rolling	Rolling massage

How to Adjust Massage

●Air massage setting (Manual massage only)

	Shoulder airbags	Turn ON/OFF the shoulder airbags
	Arm airbags	Turn ON/OFF the arm airbags
	Hip airbags	Turn ON/OFF the seat side airbags
	Foot airbags	Turn ON/OFF the foot airbags
	Calf airbags	Turn ON/OFF the calf airbags
	Whole body airbags	Turn ON/OFF the whole airbags simultaneously

●Massage range setting (Manual massage only)

	Point massage	Massage range can be selected.
	Partial massage	
	Entire massage	
	Massage ball width	Massage ball width can be adjusted in 3 levels with each button press (Available only in the "Tapping" and "Rolling" massage techniques.)
	Massage ball position adjustment	Massage ball position can be adjusted during only in the "Point" and "Partial" massage

●Bluetooth Audio playback Operation Instructions

1. Enter the main menu of the smart device, open "Settings," select the "Bluetooth" option, turn on "Bluetooth," and automatically "Search for new Bluetooth devices."
2. The device will search for the corresponding Bluetooth model (MR6000). Click the pairing button. If asked to pair with the device, select "Pair" to complete the pairing.
3. Open the music player of the smart device and select a song to play.

Cleaning and Maintenance

Clean PU leather and plastic parts

Wipe the skin with a soft dry cloth

■ Do not use chemicals such as thinner, gasoline, etc. to clean the unit.

■ When using commercially available leather care products (rags), please follow the instructions for use.

■ If the PU leather is particularly dirty, wipe it in the following way:

① Immerse a soft cloth in water or hot water containing 3% to 5% neutral detergent, then thoroughly wring it out thoroughly.

② Use the above soft cloth to wipe the leather surface.

③ Wipe off the cleaning solution with a cloth soaked in clean water and thoroughly wrung soft cloth.

④ Wipe with a wrung soft cloth.

⑤ Let it air dry naturally.

■ When it is difficult to remove stains, please immerse commercially available melamine foam in neutral detergent, and then wipe the machine with it.

■ Do not use a hair dryer to dry the surface.

■ As the color of the fabric will stain the surface of the PU leather, be careful when wiping the chair with denim and colored fabrics.

■ Do not keep these parts in contact with plastic for a long time, as this will cause discoloration.

■ PU leather may be discolored, so when using hair dye, please cover the touched part with a towel.

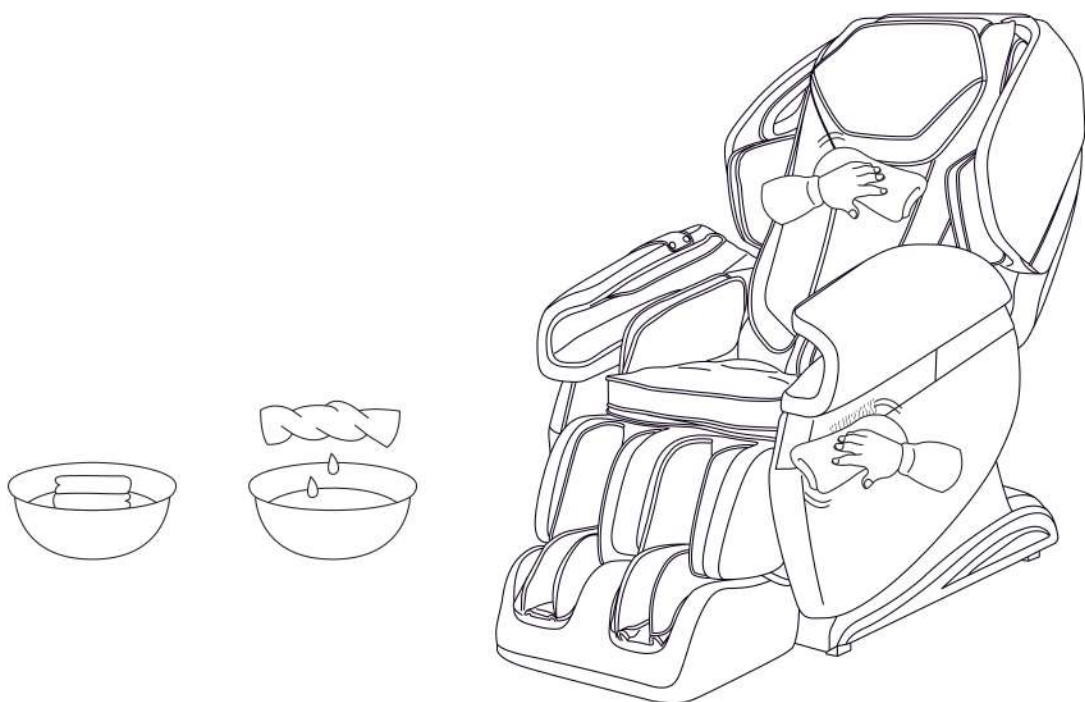

Troubleshooting

Issue	The backrest reaches a certain position, pressing the corresponding adjustment button no longer changes it, and it emits a continuous "beep, beep" sound.
Solution	Due to the product's structural design and ergonomic requirements, there are restrictive protection measures for posture adjustment. A reminder sound will be emitted when reaching the limit.

Issue	The product stopped working.
Solution	You may have used the product continuously for 45 minutes where the overheat protection has been activated. Unplug the product and let it cool down for 60 minutes before use it again.

Issue	The machine emits a squeaking friction sound during posture adjustment.
Solution	The entire product uses environmentally friendly and advanced anti-corrosive materials. Due to the inherent characteristics of these materials, slight friction noise may occur at relative motion points, which is considered normal. Note: If tearing sounds from fabric or material are heard during operation, immediately stop using it and seek professional assistance for inspection.

Issue	The massage rollers do not reach the position of the shoulders or neck.
Solution	If the head does not touch the headrest or the back does not touch the backrest, the shoulder position may be lower than the actual position during the body shape detection process. Sit in the deepest position of the chair, rest your head on the headrest, and then restart the operation from the beginning.

Issue	The machine is damaged. The power cord or power plug is abnormally heating.
Solution	To prevent accidents, please contact the authorized service center immediately.

For any uncertainties or questions regarding this product, feel free to contact the designated service personnel.

Product Specifications

Product name	CALM PLUS
Model name	MR6000
Power supply	AC110-120V 60Hz 1.7A
Rated time	30 min
Power consumption	140W
Safety structure	Class I
Maximum user weight	100kg
Country of origin	Made in China

This device complies with part 15 of the FCC Rules. Operation is subject to the following two conditions:
(1) this device may not cause harmful interference, and (2) this device must accept any interference received, including interference that may cause undesired operation.

Changes or modifications not expressly approved by the party responsible for compliance could void the user's authority to operate the equipment.

NOTE: This equipment has been tested and found to comply with the limits for a Class B digital device, pursuant to Part 15 of the FCC Rules. These limits are designed to provide reasonable protection against harmful interference in a residential installation. This equipment generates, uses and can radiate radio frequency energy and, if not installed and used in accordance with the instructions, may cause harmful interference to radio communications. However, there is no guarantee that interference will not occur in a particular installation. If this equipment does cause harmful interference to radio or television reception, which can be determined by turning the equipment off and on, the user is encouraged to try to correct the interference by one or more of the following measures:

- Reorient or relocate the receiving antenna.
- Increase the separation between the equipment and receiver.
- Connect the equipment into an outlet on a circuit different from that to which the receiver is connected.
- Consult the dealer or an experienced radio/TV technician for help.

This equipment contains a certified radio transmission module:

FCC ID : 2AOC9-ZENBDM10A

IC : 27631-ZENBDM10A

 **Bluetooth**® The Bluetooth® word mark and logos are registered trademarks owned by Bluetooth SIG, Inc. and any use of such marks by FUJIRYOKI is under license. Other trademarks and trade names are those of their respective owners.

FUJIIRYōKI
